

# Startup certificate

## Hydraulic Attachment Tools

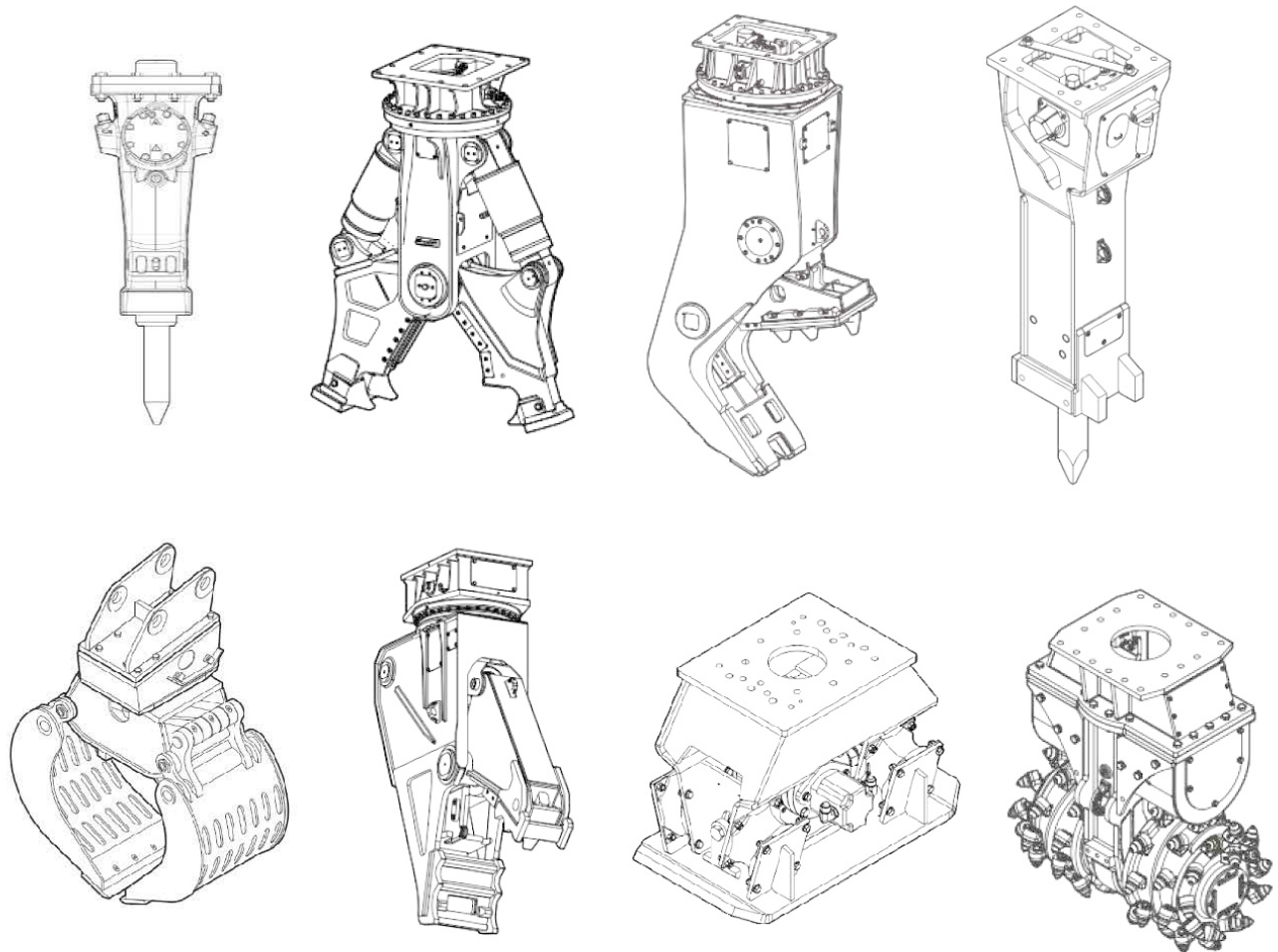

**The Startup Certificate is an important document for the subsequent processing of warranty claims.**

The warranty period starts on the date of start up. Warranty claims cannot be processed without a startup certificate being submitted to Epiroc USA LLC. Data and checks requested in the startup certificate are aimed at giving Epiroc USA LLC not only the basic information but more importantly the operating settings of the tool. As this information is required for warranty decisions, a startup certificate must be filled out.

**Please retain a copy of this certificate for your records and forward the original to:**

Service Coordinator  
Epiroc USA LLC  
7171 East Pleasant Valley Road  
Independence, OH 44131 USA

**Email to:** [hat.us.techservice@epiroc.com](mailto:hat.us.techservice@epiroc.com)

## Distributor:

### 1. Customer details

Name of the company

Date

Address

Date of last inspection

City, State, Zip

Telephone

Customer Contact

Customer email

Dealer Contact

Dealer email

### 2. Hydraulic attachment details

Model

Serial number

Standard

Dust protector

Breaker hour meter

Carrier hour meter

Operating terms

If other operating terms

Application

If other application

Piston accumulator (precharge)

PSI

Breaker temperature

HATCON

Yes

No

HATCON Serial number

### 3. Carrier / Excavator and installation details

Manufacturer

Model

Serial number

Quick coupler brand

Model

Serial number

Auxiliary kit

Auxiliary kit model / Serial number

Measurements of oil flow and oil pressure for additional circuit of hydraulic breaker (flow meter instead of hydraulic attachment)

Measuring temperature of oil: 140-160 degrees F

—— Drum cutter and SDT ——

(P) PSI	approx 0	500	1000	1500	2000	2300	2500	2600	2900	3200	3625	4350	4500	5075
(Q)GPM														
Back PSI														

Relief cracking pressure

PSI

Static pressure

PSI

Dynamic pressure

Priority flow

Measurements of oil flow and oil pressure for the rotation circuit  
(flow meter instead of hydraulic motor)

(P) PSI	approx 0	500	1000	1500	2000	2300	2500	2600	2900	3200	3625	4350	4500	5075
(Q)GPM														

**4. Lubrication**

ContiLube II

Function control

Sufficient greasing

Current adjustment (x)            mm/inch

Breaker has been pre-greased with chisel paste

Genuine chisel paste

If non-genuine, please name supplier

Remarks:

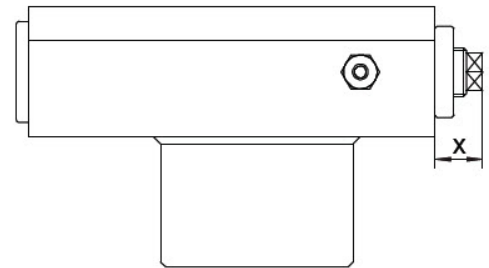

**5. Instructions**

Checked all fasteners (bolts, hoses, etc)

Operator has been instructed

Operating instructions have been given

Instructions to avoid damages have been given

Instructions to avoid injury have been given

Dust protector has been explained

ContiLube II has been explained

Remarks: